

40no. Units  
Units No: 63-66, 67-70, 71-74,  
77-80, 81-84, 109-112, 117-120,  
121-124, 125-128, 129-132,  
133-136, 137-140, 141-144,  
145-148, 148-152, 153-156,  
157-160, 161-164, 179-182,  
183-186

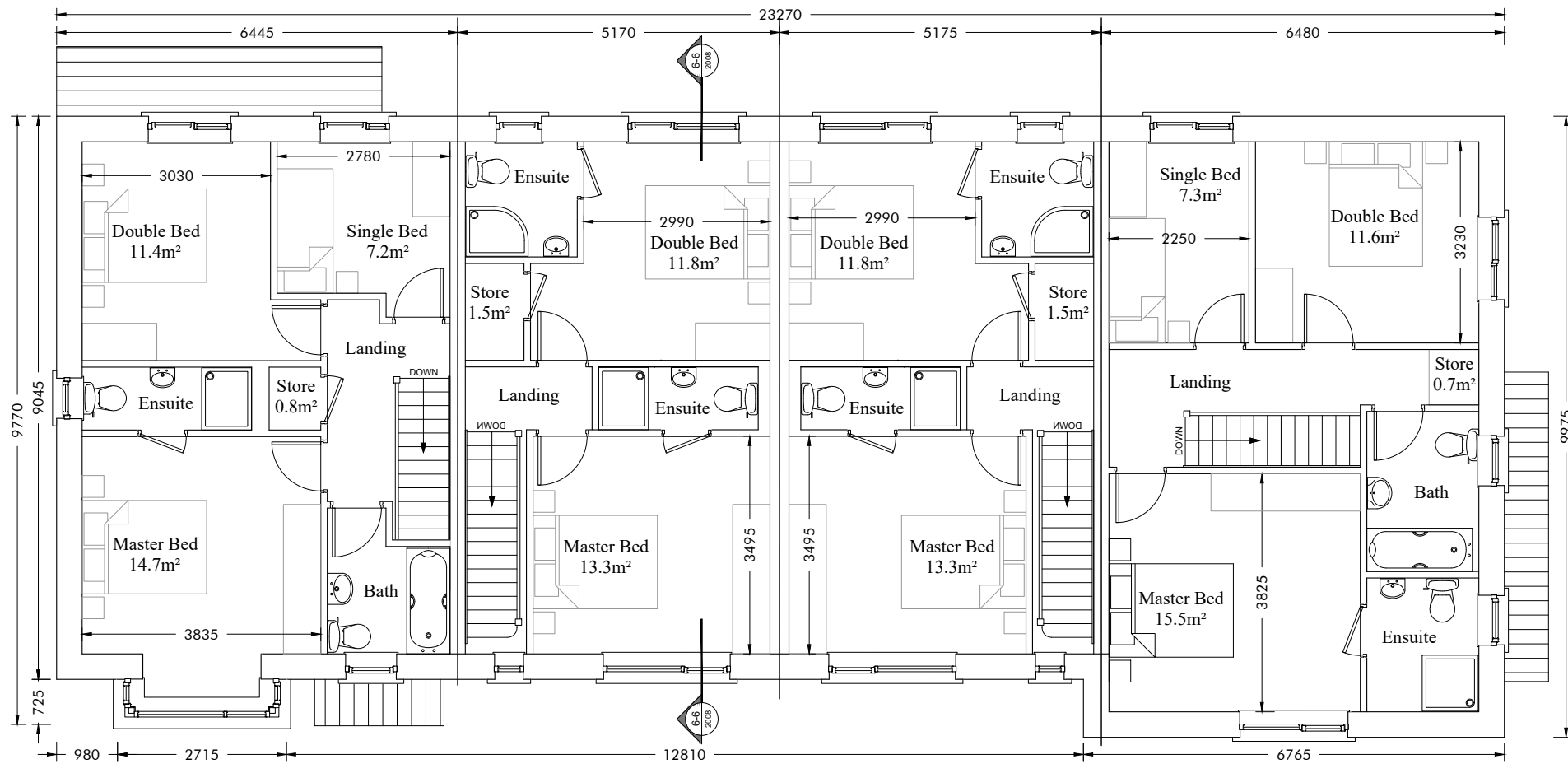

**TYPE: D1 - 50.0M<sup>2</sup>**

**TYPE: E - 40.3M<sup>2</sup>**

**TYPE: E - 40.3M<sup>2</sup>**

**TYPE: C - 54.4M<sup>2</sup>**

**FIRST FLOOR PLAN**

**Quality Housing for Sustainable Communities**  
**House Type D1 - 3bed/5p House (2 Storey)**

	Area Requirements	Type D1 Areas
Floor Area	92m <sup>2</sup>	104.4
Main Living Room	13m <sup>2</sup>	17.2
Agg. Living Area	34m <sup>2</sup>	38.8
Agg. Bedroom Area	32m <sup>2</sup>	33.3
Storage	5m <sup>2</sup>	5
Single Bed	7.1m <sup>2</sup>	7.2
Double Bed	11.4m <sup>2</sup>	11.4
Master Bed	13m <sup>2</sup>	14.7
Living Room Width	3.8m	3.9

**Quality Housing for Sustainable Communities**  
**House Type E - 2bed/4p House (2 Storey)**

	Area Requirements	Type E Areas
Floor Area	80m <sup>2</sup>	82.2
Main Living Room	13m <sup>2</sup>	30.9
Agg. Living Area	30m <sup>2</sup>	30.9
Agg. Bedroom Area	25m <sup>2</sup>	25.2
Storage	4m <sup>2</sup>	4.5
Double Bed	11.4m <sup>2</sup>	11.8
Master Bed	13m <sup>2</sup>	13.3
Living Room Width	3.6m	4.9

**Quality Housing for Sustainable Communities**  
**House Type C - 3bed/5p House (2 Storey)**

	Area Requirements	Type C Areas
Floor Area	92m <sup>2</sup>	110.1
Main Living Room	13m <sup>2</sup>	24.0
Agg. Living Area	34m <sup>2</sup>	41.9
Agg. Bedroom Area	32m <sup>2</sup>	34.3
Storage	5m <sup>2</sup>	5
Single Bed	7.1m <sup>2</sup>	7.3
Double Bed	11.4m <sup>2</sup>	11.6
Master Bed	13m <sup>2</sup>	15.5
Living Room Width	3.8m	3.8

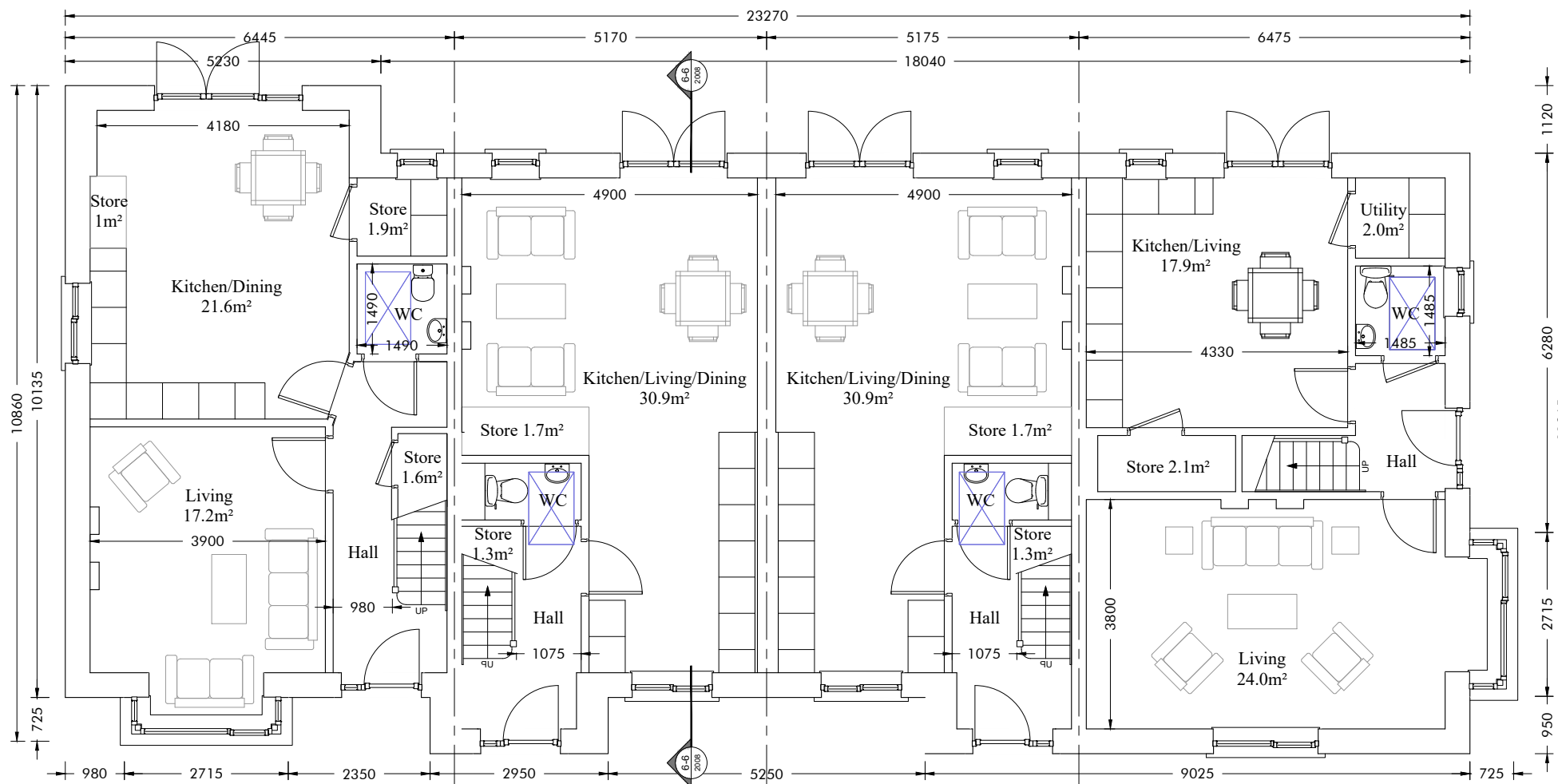

**TYPE: D1 - 54.4M<sup>2</sup>**

**TYPE: E - 41.9M<sup>2</sup>**

**TYPE: E - 41.9M<sup>2</sup>**

**TYPE: C - 55.6M<sup>2</sup>**

**GROUND FLOOR PLAN**

1	ISSUED FOR PLANNING APPLICATION	12.08.22	MOK
Rev	DETAIL	DATE	BY

**IMPORTANT TO BE READ**  
© THIS DRAWING IS COPYRIGHT

THIS DRAWING OR ANY PART THEREOF SHALL ONLY BE USED FOR THE PURPOSES SPECIFIED IN THE STAGE BOX OF THE TITLE SHEET. ALL CONSTRUCTION METHODS, MATERIALS, SERVICES AND INSTALLATIONS TO BE IN ACCORDANCE WITH ALL BUILDING REGULATIONS AND CODES OF PRACTICE AT TIME OF CONSTRUCTION. ALL SUB-CONTRACTORS ARE ULTIMATELY RESPONSIBLE FOR ENSURING COMPLIANCE WITH REGULATIONS WITHIN THEIR OWN TRADE. ALL TRADES TO CHECK DIMENSIONS ON SITE PRIOR TO CONSTRUCTION OR FABRICATION. FIGURED DIMENSIONS TO BE TAKEN ONLY. ARCHITECTS TO BE INFORMED IMMEDIATELY OF ANY DISCREPANCIES BEFORE WORK PROCEEDS. THIS DRAWING IF NOT DENOTED FOR CONSTRUCTION MAY BE SUBJECT TO ALTERATIONS FOR CONSTRUCTION. THIS DRAWING SHOULD NOT BE REPRODUCED WITHOUT PRIOR WRITTEN PERMISSION OF THE COPYRIGHT OWNERS. REVISION DESCRIPTION TO BE CHECKED FOR DESCRIPTION OF CHANGES AND PROJECT STAGE. IF IN DOUBT, ASK!

Stage Abbreviations:  
SU-Survey, SK-Sketch, PP-Preplanning, PA-Planning Application, FI-Further Information, AP-Appeal, RC-Response To Conditions, TE-Tender, FC-Fire Cert, LE-Contract / Legal, CO-Construction, AB-As Built.

**DMNA**  
Architects  
21 Patrick's Hill, Cork. T: 0214518371 E: info@dmnarchitects.ie

**Doyle McDonogh Nash**  
Landscape Architects

CLIENT:  
**O'FLYNN CONSTRUCTION  
UNLIMITED COMPANY**

JOB TITLE:  
**RESIDENTIAL DEVELOPMENT AT  
SPAGLEN, MALLOW,  
CO. CORK**

DRG. TITLE:  
**HOUSE TYPES C,D1&E  
STYLE 02 (CONTEMPORARY)  
ELEVATIONS (2OF2) & SECTION**

Drawn By:	Checked By:	Job No:	Drawing Number:	Revision:	Stage:
MO'K	KMCD	20006	2012	01	PA
SCALE:	1:100@A3				